



Salishan
SPA & GOLF RESORT

7760 101 North • P.O. Box 118
Glenden Beach, OR 97388
(541) 764-2371 • Fax: (541) 764-3670
www.salishan.com

Nestled along the scenic Oregon Coast on 350 wooded acres, the Salishan Spa and Golf Resort is a full-service luxury resort in a relaxed atmosphere. Each of our 205 guest rooms is tastefully appointed, featuring gas fireplaces and private balconies. Our breathtaking setting provides the perfect place for a wedding, reunion, high level business meeting or retreat.

Guestroom Accommodations and Amenities

- Refrigerator
- Hair Dryer
- Iron and ironing board
- Fireplace and balcony
- Pay-per-view in-room movies
- Bottled water, tea and Starbucks coffee
- Gilcrest & Soames bath products

Golf/Tennis

- 18-hole, par 71 golf course designed by Peter Jacobsen
- 350-yard putting course
- Club storage, rental and private lessons from Salishan's on-staff PGA professional.
- Three indoor Tennis Courts
- Locker rooms and a viewing lounge
- Instructors for private, semi-private lessons, or group clinics.

Dining

- The Salishan Dining Room
- The Sun Room
- The Club House
- The Attic Lounge

SHOPS @ SALISHAN	DIM.	Sq. Ft.	Ceiling Height	Theatre	U Shape	Hollow Square	Classroom	Conference	6' Exhibit Table	Banquet Table of 8
Siletz North #1	25x14	574	8.5	-	-	-	-	12	-	-
Siletz North #2	19x14	512	8.5	-	-	-	-	12	-	-
Siletz South #1	23x19	437	9	-	16	16	-	12	-	-
Siletz South #2	23x38	874	9	40	28	32	30	24	-	-

Shopping

- Lawrence Gallery, Men's and Women's apparel
- Fine wines and gourmet coffees
- The finest in kitchen and home décor, books and specialty candies, floral creations and beautiful handcrafted jewelry

Spa & Salon

- Full line of Spa products
- Outdoor whirlpool
- Men's and women's private Jacuzzi's
- Relaxation lounge with fireplace
- Sauna and steam rooms

Swimming and Fitness

- Indoor swimming pool
- Hydrotherapy pool
- Fitness room with state of the art equipment

Meeting Facilities and Services

- 16,000 square feet of flexible meeting space with each having access to natural lighting
- On site A/V technician with state of the art equipment for presentations
- An outdoor area provides a private natural setting for wedding groups up to 150.

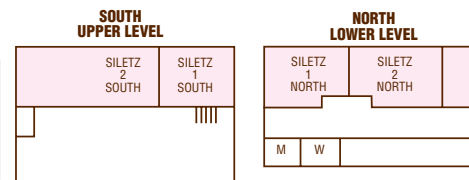

MEETING ROOMS

FLOOR PLANS

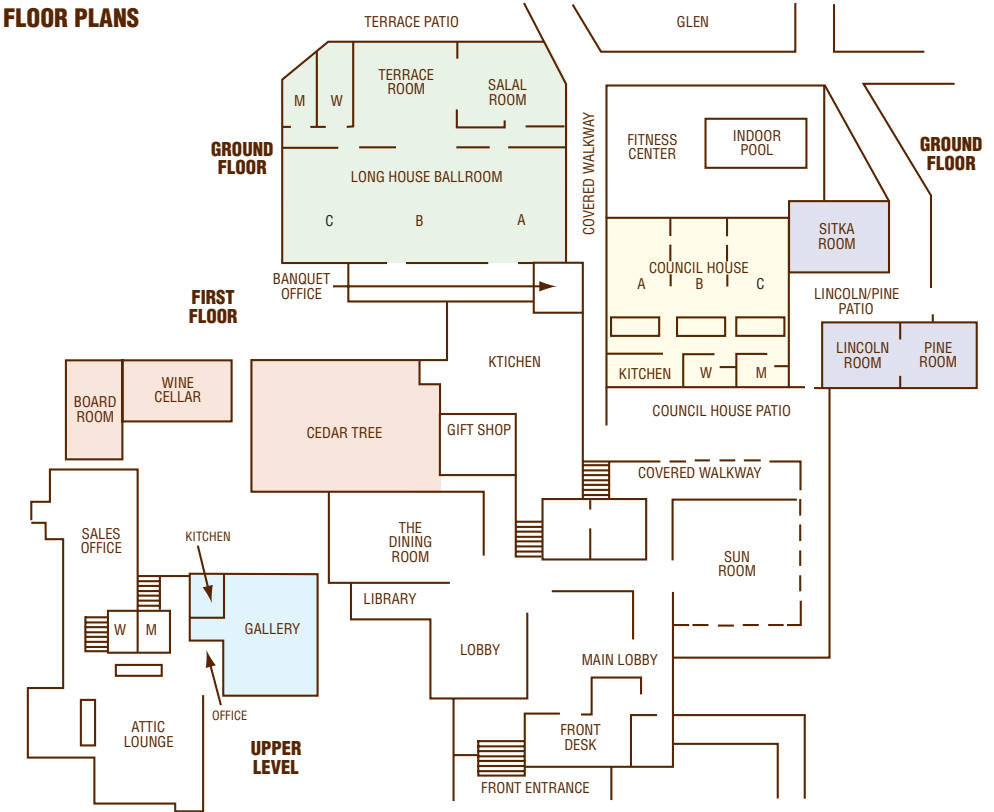

GROUND FLOOR	DIM.	Sq. Ft.	Ceiling Height	Theatre	U Shape	Hollow Square	Classroom	Conference	6' Exhibit Table	Banquet Table of 8
Lincoln/Pine Room	67x24	1608	8.5	120	36	40	72	32	14	96
Lincoln Room	24x30	720	8.5	60	18	30	36	16	7	48
Pine Room	24x30	720	8.5	60	18	30	36	16	7	48
Sitka Room	19.5x33.5	653	8.5	50	18	24	30	14	6	24
LONG HOUSE BALLROOM										
Salal Room	16.5x19.5	322	9	24	15	18	12	8	8	16
Terrace Room	24x31	744	9	60	18	20	48	16	11	48
Long House	85x52	4,420	14	350	60	78	250	40	61	272
Long House A or C	29.5x52	1,534	14	100	35	48	72	24	24	112
Long House B	23.5x52	1,222	14	80	35	48	60	24	21	80
Long House A+B, B+C	53x52	2,756	14	200	52	60	126	28	34	184
COUNCIL HOUSE										
Council House	72x36	2,592	13.5	225	42	60	156	40	34	200
Council House A, B or C	24x36	864	13.5	72	24	36	60	20	11	64
Council House A+B, B+C	48x36	1,728	13.5	150	36	48	96	20	22	128
FIRST FLOOR										
Cedar Tree	44x54	2376	9	175	42	60	90	20	34	120
Wine Cellar	9.5x37	351	9	0	0	0	0	20	-	0
Boardroom	35x14	490	9	0	0	0	0	20	-	0
SECOND FLOOR										
Gallery Room	36x36	1,296	9	120	33	48	60	20	17	72